



**FLUE KITS &  
COMPONENTS**  
RETAIL PRICES



# Easy Ordering

---

## Online & Email

---

**Email** : [info@sfp.co.nz](mailto:info@sfp.co.nz)

---

**Website** : [www.sfp.co.nz](http://www.sfp.co.nz)

## We're Online!

---

Did you know that all of our products are online for ordering and information

Just enter the product codes in this price guide in the search bar to get browsing!



## Sales and Enquiries

---

**Phone** : (09) 274 4421

---

**Factory Address:** 26 Stonedon Drive  
East Tamaki

---

**Price list Effective From 1st March 2019**

# Things You Need To Know

---

## PRICE LIST

- Goods ordered from this price list are subject to the terms and conditions contained in our standard terms and conditions in force at the time of making of your order.
- All prices are correct at the time of publication of this price list. We reserve the right however to change the prices listed in this document without notice.
- We recommend that at the time of making an order you confirm with our sales staff that the goods are available, and the price stated on the price list is still the correct price in respect of the product in question.
- All wholesale prices are exclusive of GST and freighting costs.
- Retail prices shown are suggested retail prices only and inclusive of GST.

## PRODUCT RETURNS

- SFP reserve the right to deduct freight costs plus a restocking and repacking fee on all returned goods incorrectly ordered.
- Goods cannot be returned if they have been custom-made.
- Please check with us before returning any goods.

## FREIGHT CLAIMS

- All claims for damages and short deliveries must be made on receipt of goods and must be signed for as damaged or short landed.
- Damaged or short delivery must be noted on all copies of the freight consignment note at time of delivery, while delivery driver is still there.
- Signed for "subject to inspection" is not acceptable and will void the possibility of lodging a claim if damage or short supply is found at a later time.
- Any damage or short delivery once noted on the consignment note must be reported immediately to SFP by email, with a copy of the consignment and photos of damage or details of the missing good(s).



# TERMS AND CONDITIONS OF SALE

## 1. Consumer Guarantees Act 1993

- 1.1 Nothing in these Conditions of Sale and Service shall restrict, negate, modify or limit any of your rights under the Consumer Guarantees Act 1993 where:
- 1.1.2 The goods you are acquiring are of a kind ordinarily acquired for personal, domestic or household use or consumption; and
- 1.1.3 You are not acquiring the goods for a business purpose.

## 2. Acceptance of Orders

- 2.1 We, SFP (2017) Ltd, will only supply you, the customer, with goods on these terms unless we have agreed in writing to different terms.

## 3. Price

- 3.1 The price of the goods:
  - 3.1.1 Will be our current prices at the date of delivery unless we have quoted a firm price;
  - 3.1.2 Always exclude GST, unless otherwise stated, and the amount of such tax shall be added to the price of the goods; and
  - 3.1.3 Does not include the cost of delivering the goods to you.
  - 3.1.4 May be increased if we incur higher freight, insurance, import charges or higher foreign exchange costs after the order is placed, or if we incur extra costs because you did not provide us with information or licenses by the time we required.
  - 3.1.5 When we have quoted a firm price and no period of effectiveness is given, then the price will only apply for 90 days from the date of the quote.

## 4. Payment

- 4.1 You must pay us the price by the 20th of the month following the date of our invoice, unless otherwise agreed. If you do not, we will be entitled to:
  - 4.1.1 Defer supplying you with any more goods;
  - 4.1.2 Charge you penalty interest on the amount owing to us at the rate stated in our statement and/or invoice from the time the payment was due;
  - 4.1.3 Treat the contract as having been cancelled by you;
- 4.2 You agree to indemnify us for all costs and expenses (including costs and expenses) we may incur as a consequence of your failure to pay the purchase price in accordance with this clause 4.0.
- 4.3 If we reasonably believe that you will not pay any monies to us for any reason, then we may demand from you:
  - 4.3.1 Payment in full of any monies owing to us;
  - 4.3.2 That you provide us with adequate collateral to secure the payment of all monies owing to us before we commence, or continue to manufacture and/or deliver goods to you.
  - 4.3.3 We may in our discretion apply any payments we receive from you towards any indebtedness you may have with us. We are bound by any conditions or qualifications that you may make in relation to any payments made to us.

## 5. Title and Risk

- 5.1 Goods are at your risk as soon as they have been delivered to you. For the purposes of this clause 5.0 and clause 6.0 delivery shall be deemed to have taken place once:
  - a) when we have accepted your order; and
  - b) the goods are on our premises; and
  - c) the goods are set aside for sending to you; and
  - d) either transit arrangements have been made for the goods, or the goods are ready for collection.
- 5.2 We remain the owners of the goods we supply you until you have paid in full all amounts that you owe to us for all the goods we have supplied to you:
- 5.3 While we are the owners of the goods:
  - 5.3.1 You will always keep the good clearly identified as our property;
  - 5.3.2 We will still own the goods even if you repackage them;
  - 5.3.3 If you mix the goods with other material, we will own the mixture that equals the proportion that the cost of our goods bears to the total cost of the materials comprising the mixture;
  - 5.3.4 You may sell the goods only if you keep enough of the sales proceeds to pay us for the goods in a separate bank account in trust for us;
  - 5.3.5 You license us to enter any of your premises during normal business hours to repossess the goods while you owe us money. You cannot revoke this license.

- 5.3.6 The fact that we own the goods will not affect our right to sue you for the price if you do not pay us on time. We have no obligation to accept returned goods instead of being paid for them. We have no obligation to do anything to limit any loss we might suffer if you do not pay us on time.

## 6. Delivery

- 6.1 We will, at your cost, freight the goods to you by whatever method and route we consider to be the most expedient. The cost of the freight will be shown separately on our invoice.
- 6.2 Where you require us to freight the goods to you urgently, we reserve the right to charge you for any additional freighting expenses incurred.
- 6.3 If you have specified a delivery date, we will try and deliver the goods by that date, however:
  - 6.3.1 We will be entitled to deliver the goods to you after the agreed delivery date or cancel the contract without being liable to you in respect of causes outside our control;
  - 6.3.2 We may deliver the goods to you by instalments in any quantity and each delivery will be a separate contract independent from the other deliveries.
- 6.4 If you do not specify a reasonable time for delivery of the goods, and we have not accepted any such time specified for delivery, we will not be liable to you for late delivery of the goods in any circumstances.
- 6.5 You may not refuse to accept delivery of goods where we have agreed in writing.

## 7. Exclusions and Limitations to our Liability

- 7.1 Subject to clause 1 of the Conditions, where we are permitted by law, we exclude or contract out of all warranties other than those expressly stated in these terms and conditions.
- 7.2 We will not be bound by any representations that we make unless they are writing.
- 7.3 We give all technical advice or assistance entirely at your risk.
- 7.4 We warrant only that the goods comply with our specifications where we are the manufacturer or that they comply with the manufacturer's specifications where we are not the manufacturer.
- 7.5 All descriptions of the goods are to only enable their identification and does not mean that the sale of the goods is a sale by description.
- 7.6 We will not be liable to you for any direct, indirect or consequential loss in respect of the goods, or for any delay or failure to supply the goods except where it is due to our gross negligence or wilful default. However our liability to you in that instance is limited to the amount that we may receive from the manufacturer if we are not the manufacturer or to the sale price of the goods where we are the manufacturer.
- 7.7 We will not be liable to you for any direct, indirect or consequential loss in respect of the goods as a consequence of improper installation, maintenance, accident, neglect, misuse or operation of the goods beyond their rated capacity.

## 8. Claims

- 8.1 We will at our own option replace or give a credit to you for any goods which contain a manufacturing defect if:
  - 8.1.1 You advise us of your claim within 30 days of such a defect becoming apparent in the goods, quoting the despatch number and/or invoice number where appropriate.
  - 8.1.2 Your claim identifies the manufacturing defect, and the nature of your claim.
  - 8.1.3 You obtain our consent to the return of the goods, prior to returning the goods to us.
  - 8.1.4 The goods are returned to us in the same condition they were received by you.
  - 8.1.5 You will pay for the cost of returning the goods.
  - 8.1.6 You will pay our handling fee.
- 8.2 If you dispute any item or amount contained in any invoice, you must advise us or such a claim within 30 days after receipt of that invoice. If you fail to give us such notice you will be deemed to have accepted the contents of the respective invoice.

## 9. Indemnity

- 9.1 Where you acquire the goods for the purpose of resupplying them to a customer other than yourself, then it is agreed that you will contract out of the application of the Consumer Act Guarantees Act 1993 within the contract for the resupply of the goods, where you are reselling the goods to a business.

- 9.2 If you fail to contract out of the Consumer Guarantees Act 1993 in accordance with clause 9.1 above then you will indemnify us for any damage or expenses that we may incur as a result of any claim being brought against us by a customer who purchases the goods from you, which would have been otherwise barred has you contracted out of the Consumer Guarantees Act 1993.

- 9.3 You will indemnify us for any liability that we may incur which arises as a consequence of representations made by you about any of the goods which are made otherwise than in accordance with our express specification and warranties which accompany the product.
- 9.4 You will indemnify us for any liability that we may incur which arises as a consequence of any claim by your customers, servants, agents, or other person in respect of any loss, damage or injury incurred as a consequence of any defect in the goods.

## 10. Return of Goods

- 10.1 We will only be liable to you for shortfalls, losses, damage or failure to meet specifications where you have notified us of those matters within 7 days of taking delivery.
- 10.2 Goods which do meet your order may not be returned to us unless:
  - 10.2.1 We have agreed in writing that they may be returned
  - 10.2.2 You have not had the goods for more than 7 days
  - 10.2.3 You will pay for the cost of returning the goods
  - 10.2.4 You will pay our handling fee
- 10.2.5 The goods are still of a fit and merchantable quality, and the goods and the packaging are not soiled or damaged.

## 11. Quotes

- 11.1 Where these terms and conditions form part of a written quote, the quote shall only remain valid for 30 days from the date of the making of the quote; and may be withdrawn by us at any time prior to the quote being accepted by you.
- 11.2 You must give us notice in writing of your acceptance of any quote we may give you.

## 12. Goods for Sale Only in New Zealand

- 12.1 You may only sell or use the goods in New Zealand and must not allow them to be exported without our prior written agreement.

## 13. Intellectual Property

- 13.1 All our trademarks or other intellectual property rights in respect of the goods remain our property and you may not use, remove, interfere with or alter them in any way.
- 13.2 We make no representation that the goods will not infringe the intellectual property rights of any other person and will not be liable for any costs that you may incur as a result. You will notify us immediately if you receive a claim from a person alleging that it is the owner of any intellectual property rights relating to the goods and if we consider ourselves to be affected, we shall be entitled to completely control the defence or settlement of the claim.
- 13.3 You will indemnify us against all damages, losses and liabilities we may incur as a consequence of any work which we shall undertake in accordance with your instructions of your customer which infringe, or allegedly infringe any third parties intellectual rights.

## 14. Assignment

- 14.1 You may not assign your rights to delegate your performance under this agreement without our consent in writing.

## 15. Proper Law

- 15.1 These conditions shall be interpreted and governed by the law of New Zealand.

## 16. Arbitration

- 16.1 We may refer any disputes between us to an arbitrator who shall be a person appointed by the President of the New Zealand Chamber of Commerce.

## 17. Waiver

- 17.1 In the event that either of us fail to perform an obligation under these Conditions of Sale and Service, and the non-defaulting party does not elect to enforce that obligation, then the non-defaulting party's inaction shall not prevent that party from enforcing that obligation at a later date, and does not constitute a waiver of any of the terms and conditions contained in these Conditions by the non-defaulting party.







# Woodfire Free Standing Flue Kits

## Flue Kit 3.6 metre (1200 Kit) contains:

- 3 x 1200mm lengths Flue Pipe
- 1 x 1200mm length Outer/Inner Casing Combination
- 1 x Anti Down-Draught Cowl
- 1 x Casing Cover
- 1 x Top Spacer Bracket
- 1 x Ceiling Plate
- 1 x Pkt Screws & Spacers

## Flue Kit 3.6 metre (1800 Kit) contains:

- 3 x 1200mm lengths Flue Pipe
- 1 x 1200mm length Outer/Inner Casing Combination
- 1 x 600mm length Outer Casing Extension
- 1 x Anti Down-Draught Cowl
- 1 x Casing Cover
- 1 x Top Spacer Bracket
- 1 x Ceiling Plate
- 1 x Pkt Screws & Spacers

## Flue Kit 4.0 metre (2400 Kit) contains:

- 3 x 1200mm lengths Flue Pipe
- 1 x 600mm length Flue Pipe
- 1 x 1200mm length Outer/Inner Casing Combination
- 2 x 600mm length Outer Casing Extension
- 1 x Anti Down-Draught Cowl
- 1 x Casing Cover
- 1 x Top Spacer Bracket
- 1 x Ceiling Plate
- 1 x Pkt Screws & Spacers

Diagram illustrates 150mm (1200) Flue Kit with Flue Pipe Shield

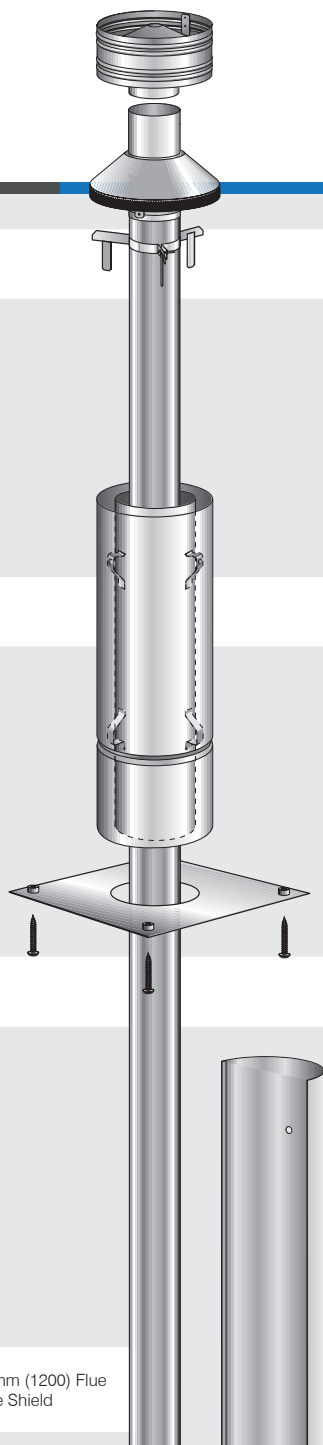

# 4.0 Metre Free-Standing Flue Kits 2400

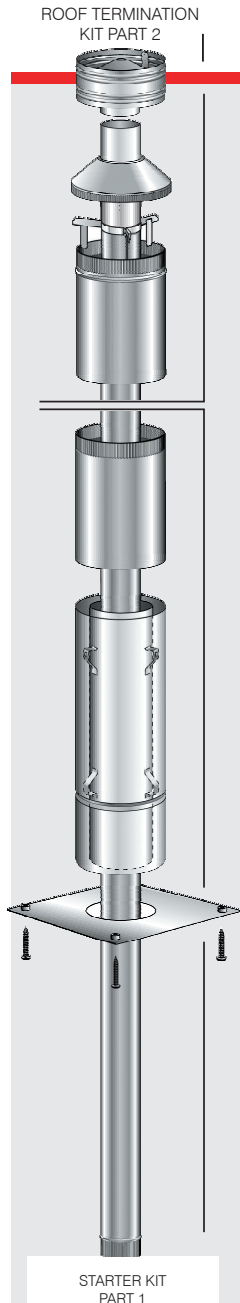

2400 Kits include a 600mm long, 250mm dia. Outer Casing and 250mm dia. Outer Casing Slip Extension

## **Stainless Steel - FKSSI5022R**

100mm

100mm with Single F/Shield

125mm

125mm with Single F/Shield

150mm

**150mm with Single F/Shield**

175mm

175mm with Single F/Shield

*Stainless Steel Outer Casing option available*

## **Hi-Therm® Metallic Black - FKHTMB22R**

100mm

100mm with Single F/Shield

150mm

**150mm with Single F/Shield**

*Stainless Steel Outer Casing option available*

4.0 metre 2400 kits also available with 1200mm long, 250mm dia. Outer Casing Slip Extension. Please specify when ordering

4.0 metre kits meet the Flue Pipe height requirements of AS/NZS 2918:2001 (4.6m rule) for a standard 2.4m stud height and a Wood Burner height of 600mm or greater

# 4.0 Metre Combination Cowl Free-Standing Flue Kits 2400

ROOF TERMINATION  
KIT PART 2

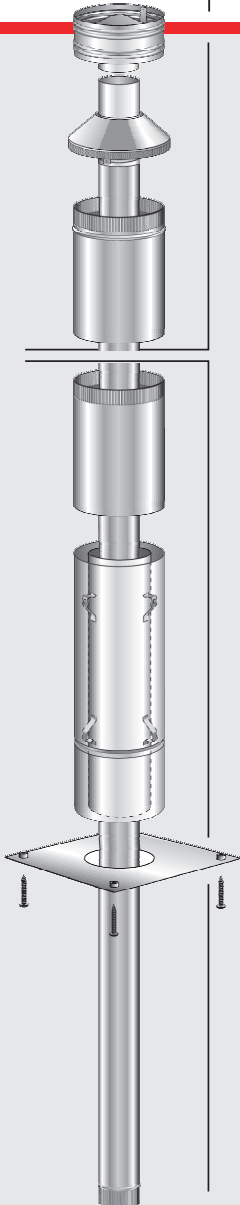

STARTER KIT  
PART 1

2400 Kits include a 600mm long, 250mm dia. Outer Casing and 250mm dia. Outer Casing Slip Extension

## **Stainless Steel - FKSSCC22R**

150mm

**150mm with Single F/Shield**

*Stainless Steel Outer Casing option available*

## **Hi-Therm® Metallic Black - FKHTMBCC22R**

150mm

**150mm with Single F/Shield**

*Stainless Steel Outer Casing option available*

4.0 metre 2400 kits also available with 1200mm long, 250mm dia. Outer Casing Slip Extension. Please specify when ordering

4.0 metre kits meet the Flue Pipe height requirements of AS/NZS 2918:2001 (4.6m rule) for a standard 2.4m stud height and a Wood Burner height of 600mm or greater

Diagram illustrates 150mm Kit, with 2 piece Outer Casing Extension

## 3.6 Metre Free-Standing Flue Kits 1800

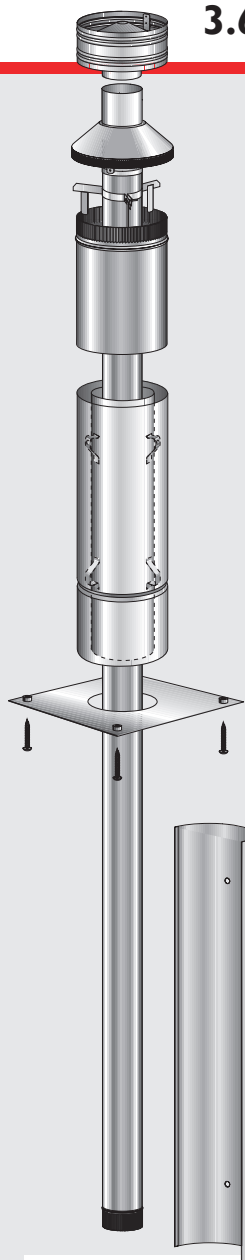

Diagram illustrates 150 Kit with Flue Pipe Shield.

1800 Kits include a 600mm long, 250mm dia. Outer Casing Slip Extension

### **Stainless Steel - FKSS15018R**

100mm

100mm with Single F/Shield

108mm

108mm with Single F/Shield

115mm

115mm with Single F/Shield

125mm

125mm with Single F/Shield

150mm

**150mm with Single F/Shield**

*Stainless Steel Outer Casing option available*

### **Hi-Therm® Metallic Black - FKHTMB18R**

150mm

**150mm with Single F/Shield**

*Stainless Steel Outer Casing option available*

To comply with the height requirements of AS/NZS 2918:2001 (4.6 metre rule) additional Flue Pipe and/or Casings must be added



## 3.6 Metre Free-Standing Flue Kits 1200

1200 Kits **DO NOT** include a 600mm long, 250mm dia. Outer Casing Slip Extension

### Stainless Steel - FKSS15012R

100mm

100mm with Single F/Shield

108mm

108mm with Single F/Shield

115mm

115mm with Single F/Shield

125mm

125mm with Single F/Shield

150mm

**150mm with Single F/Shield**

*Stainless Steel Outer Casing option available*

### Hi-Therm® Metallic Black - FKHTMB12R

150mm

**150mm with Single F/Shield**

*Stainless Steel Outer Casing option available*

To comply with the height requirements of AS/NZS 2918:2001 (4.6 metre rule) additional Flue Pipe and/or Casings must be added

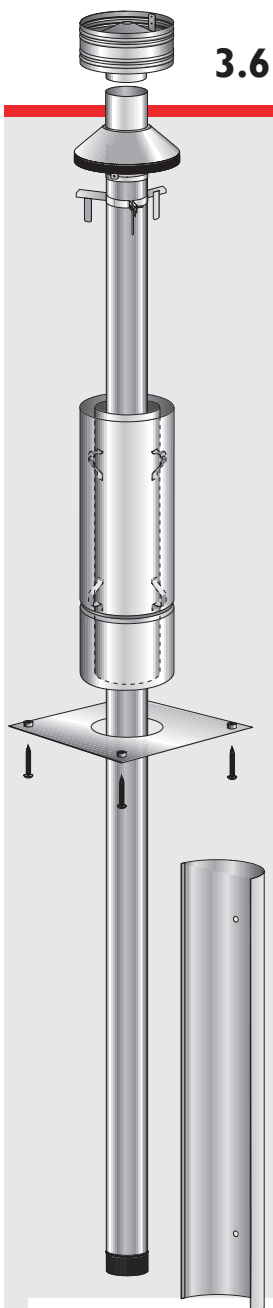

Diagram illustrates 150 Kit with Flue Pipe Shield.

**ATTACH PRINTOUTS TO THIS PAGE**



# Chimney Flue Kits

## 150mm Chimney Flue Kit contains:

- 3 x 1200mm lengths of Stainless Steel Flue Pipe
- 1 x 600mm length of Stainless Steel Flue Pipe
- 1 x 600mm length of Galv. Outer Casing, 250mm dia.
- 1 x Anti Down-Draught Cowl
- 1 x Casing Cover
- 1 x Top Spacer Bracket
- 1 x Galv. Chimney Flashing Plate (optional)

## 150mm Chimney Flue Kit (Combination Cowl) contains:

- 3 x 1200mm lengths of Stainless Steel Flue Pipe
- 1 x 400mm length of Stainless Steel Flue Pipe
- 1 x 600mm length of Galv. Outer Casing, 250mm dia.
- 1 x Anti Down-Draught Cowl Combination Cowl
- 1 x Galv. Chimney Flashing Plate (optional)

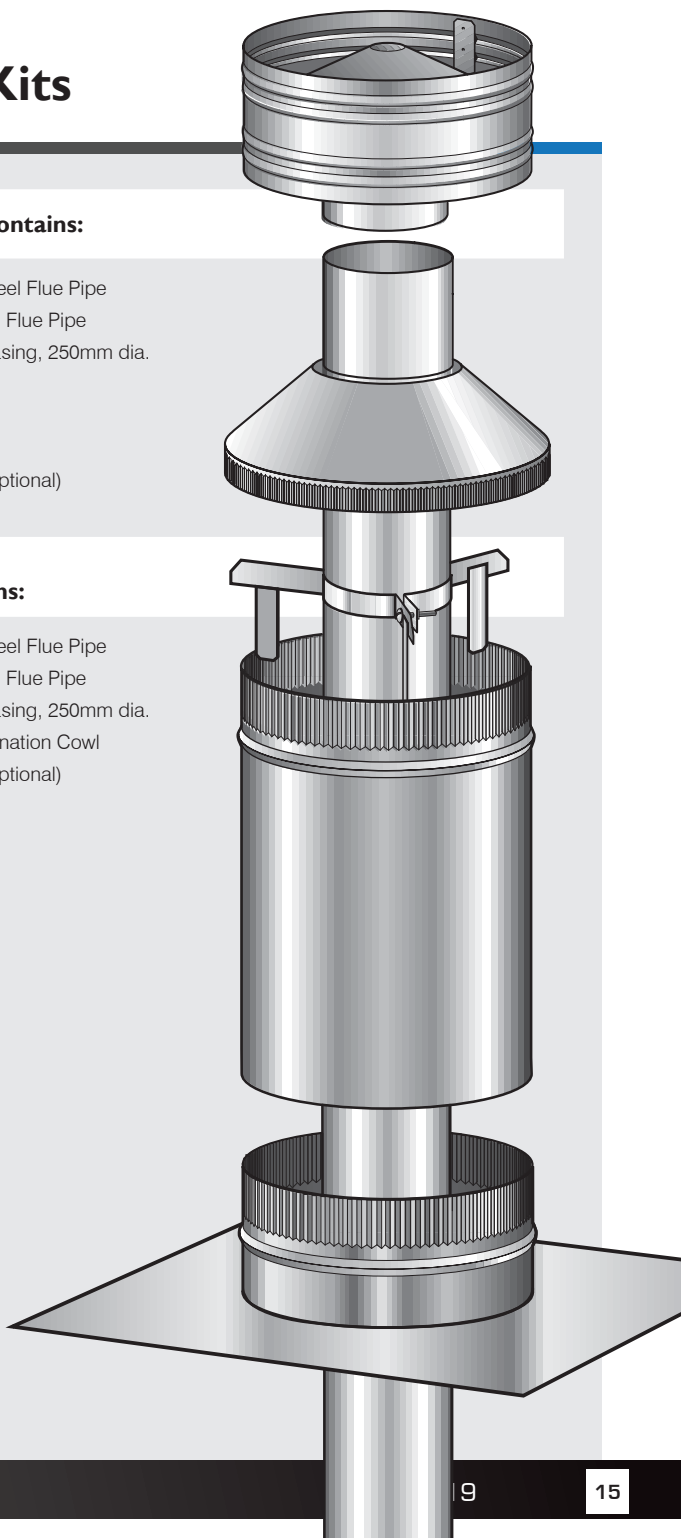

## 4.0 Metre Chimney Flue Kits

### Stainless Steel - FKIB150W

150mm

**150mm with Chimney Plate**

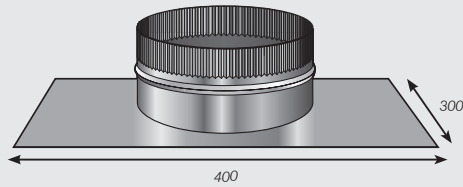

PLEASE NOTE: If Chimney Flashing Plate is required, please select when ordering

4.0 metre kits meet the Flue Pipe height requirements of AS/NZS 2918:2001 (4.6m rule) for a standard 2.4m stud height and a Wood Burner height of 600mm or greater

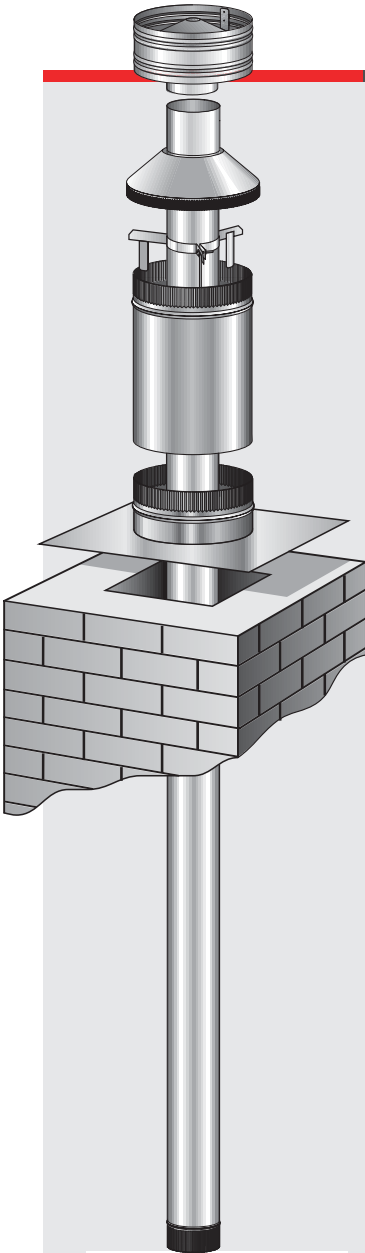

Diagram illustrates 150 Kit with optional Chimney Flashing Plate.

# 4.0 Metre Combination Cowl Chimney Flue Kits

## Stainless Steel - FKIBCC150W

150mm

**150mm with Chimney Plate**

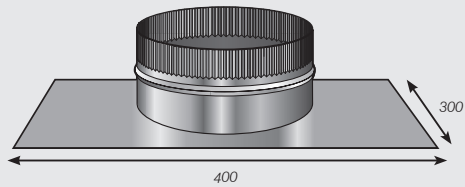

PLEASE NOTE: If Chimney Flashing Plate is required, please select when ordering

4.0 metre kits meet the Flue Pipe height requirements of AS/NZS 2918:2001 (4.6m rule) for a standard 2.4m stud height and a Wood Burner height of 600mm or greater

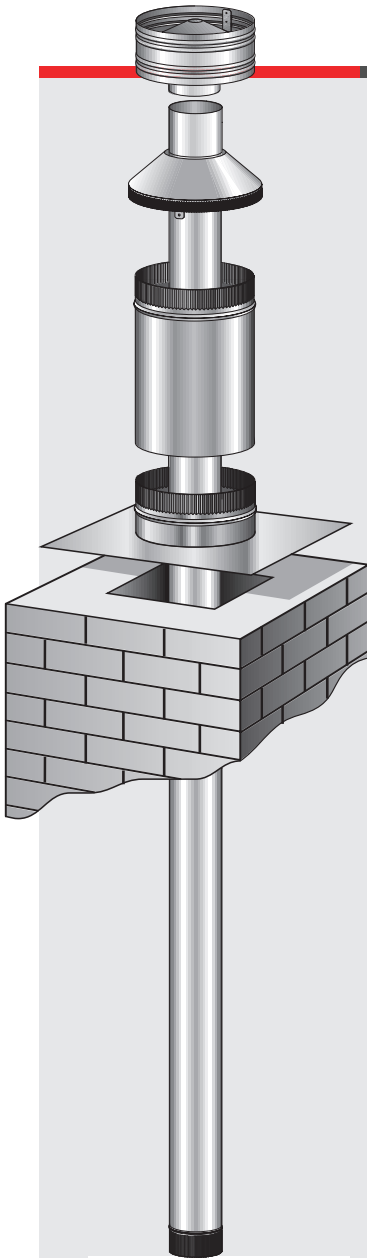

Diagram illustrates 150 Kit with optional Chimney Flashing Plate.

# Energy / Heat Saving Type Flue Kits

- Energy/Heat Saving type kits rely on a thermo-syphon principle where air from either the ceiling cavity or outside is drawn into the Outer Casing and “cools” the flue system.
- Energy/Heat Saving type flue kits minimise room air from being drawn up the Outer Casing and being “wasted”.
- The E Kit Option has been developed by SFP as a basic conversion kit. It is a practical solution, no need to stock both Energy/Heat Saving type kits and conventional kits. Simply add the E Kit Option to any SFP 150mm free-standing flue kit.

The **E Kit Option** has been tested to AS/NZS2918:2001 Report No. 03/815 & 03/833.

**NB: The E Kit Option can only be used on SFP 150mm Free-Standing Kits, SFP Ceiling Kits or with SFP components.**

**The E Kit Option can be used on heaters tested to AS/NZS2918:2001 Appendix B**

**On Metro heaters, SFP recommend the use of Pioneer Eco Flue Kits**

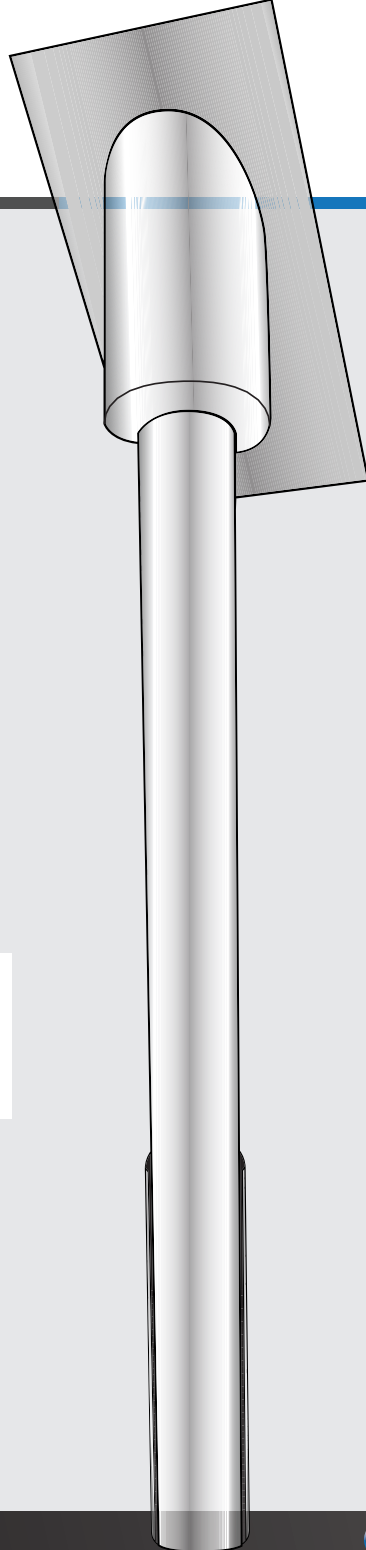

# E Kit Option

## 150mm E Kit Option - EK150

### 150mm

The **E Kit Option** is an option that converts a 150mm SFP Free-Standing Flue Kit to an Energy/Heat Saving type Kit on flat ceilings.

The easy fitting **E Kit Option** reduces heat loss from the room. Refer to installation instructions.

Manufactured in accordance with AS/NZS 2918:2001 and tested to appendix F.

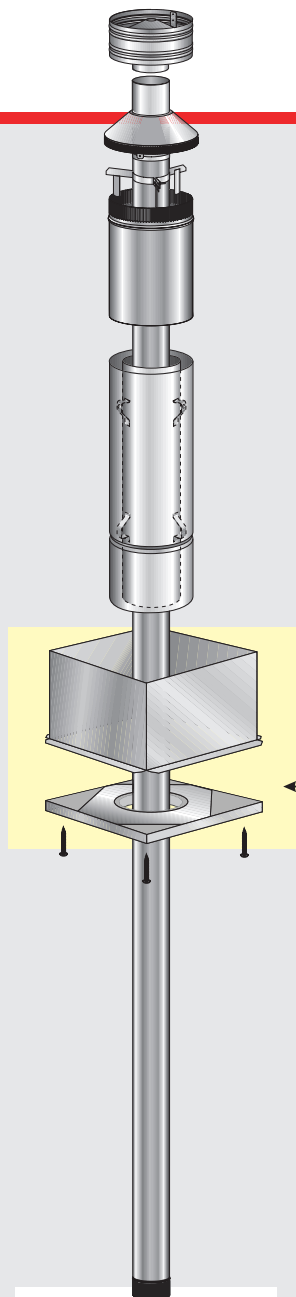
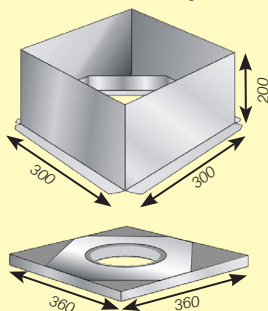

Diagram illustrates 150 Kit with E Kit Option in position

### 150mm E Kit Option



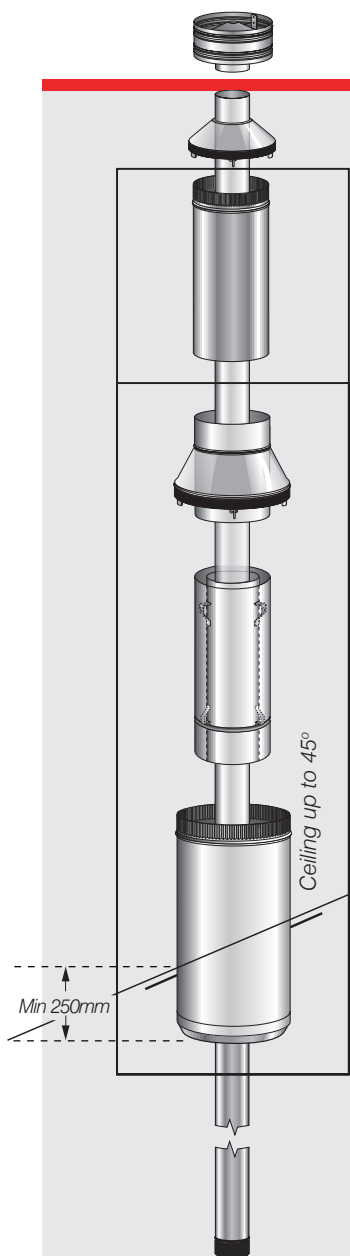

Diagram illustrates 150mm Flue Kit with Stainless Steel Sloped Ceiling E Kit Option in position

## 150mm Sloped Ceiling E Kit Option

**Option 1 Galvanised**

**Option 2 Stainless Steel**

*See opposite page for components.*

The E Kit Option is an option that converts a 150mm SFP Free-Standing Flue Kit to an Energy/Heat Saving type Kit on sloped ceilings.

The easy fitting E Kit Option reduces heat loss from the room. Refer to installation instructions.

Manufactured in accordance with AS/NZS 2918:2001 and tested to appendix F.

### Galvanised Kit contains:

- 1x S/Steel E Kit Option Casing Cover 250mm - 300mm
- 1x Galvanised Outer Casing 300mm x 1200mm with internal mounting frame
- 1x 300/155mm Galvanised Trim End Cap
- 1x 300mm Galvanised Trim Plate

### Stainless Steel Kit contains:

- 1x 600mm length, 250mm dia. S/Steel Outer Casing Extension
- 1x E Kit Option Casing Cover 250mm-300mm
- 1x Stainless Steel Outer Casing 300mm x 1200mm with internal mounting frame
- 1x 300mm dia. Galvanised Trim End Cap
- 1x 300mm dia. Galvanised Trim Plate



# Sloped Ceiling E Kit Option

## Option 1: Galvanised - SFPOK1

## Option 2: Stainless Steel - SFPOK2

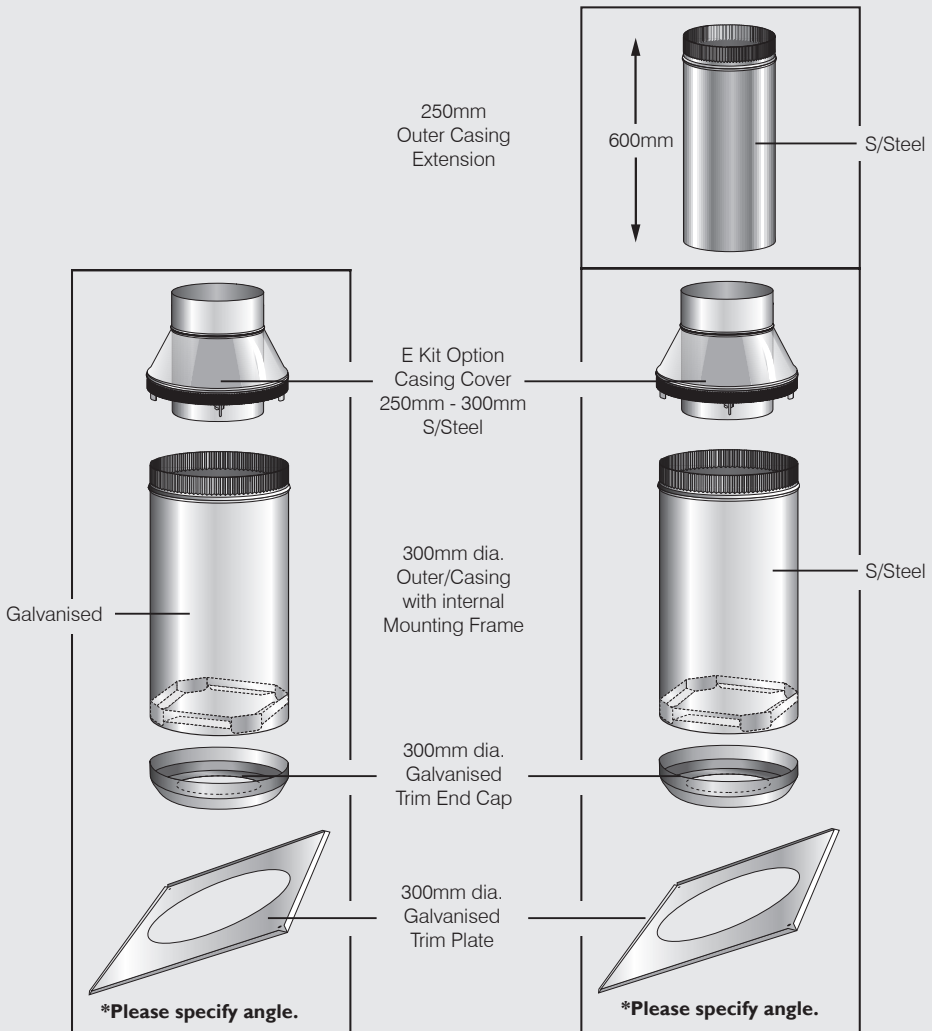

# Ceiling Penetration Trim Units Galvanised

**Suggested  
Retail only  
(incl GST)**

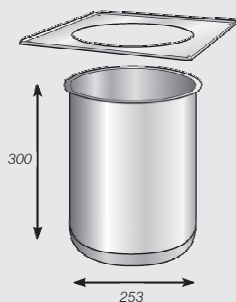

## Type 1 C.P.T.U. Flat Ceiling - CPTU1

**250mm unpainted**

**105.00**

Slips over 250mm Outer Casing

For use on untested installations as per AS/NZS 2918:2001  
Please enquire about suitable applications or refer to AS/NZS 2918:2001

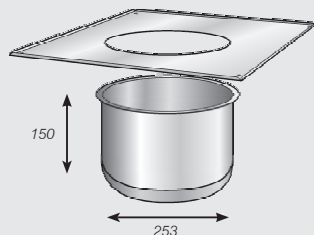

## Type 2 C.P.T.U. Flat Ceiling - CPTU2

**250mm unpainted**

**105.00**

Slips over 250mm Outer Casing

For use on untested installations as per AS/NZS 2918:2001  
Please enquire about suitable applications or refer to AS/NZS 2918:2001

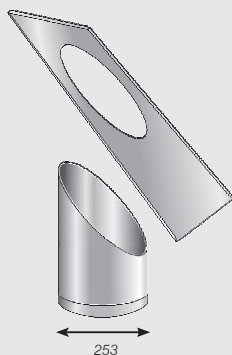

## Type 3 C.P.T.U. Flat Ceiling - CPTU3

**250mm unpainted**

**192.00**

Slips over 250mm Outer Casing

This ceiling penetration unit is designed for use on sloped ceilings

**PLEASE STATE CORRECT ANGLE WHEN ORDERING.**

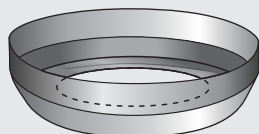

## C.P.T.U. Trim Cap - OCTC250

**250/180mm Galvanised**

**31.00**

All products on this page are manufactured in accordance with AS/NZS 2918:2001 and tested to Appendix F















# Flue Pipes Stainless Steel

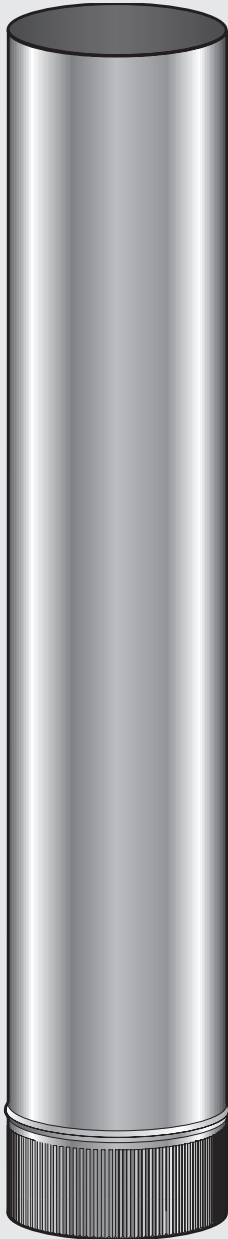

**Suggested  
Retail only  
(incl GST)**

## **1200mm lengths - FPI5012**

100mm	65.00
108mm	65.00
115mm	65.00
125mm	65.00
<b>150mm</b>	<b>65.00</b>
175mm	84.00
200mm	89.00
225mm	103.00
250mm	110.00
275mm	127.00
300mm	127.00
325mm	157.00
350mm	162.00
400mm	184.00
450mm	227.00

## **900mm lengths - FPI509**

125mm	54.00
<b>150mm</b>	<b>54.00</b>
200mm	77.00
250mm	94.00
300mm	115.00

## **600mm lengths - FPI506**

100mm	38.00
125mm	38.00
<b>150mm</b>	<b>38.00</b>
175mm	56.00
200mm	56.00
225mm	63.00
250mm	66.00
300mm	79.00
350mm	98.00
400mm	119.00

# Metallic Black Flue Pipes



**Suggested  
Retail only  
(incl GST)**

## **Hi Therm® 1200mm lengths - FHTMB150**

100mm	90.00
-------	-------

<b>150mm</b>	<b>90.00</b>
--------------	--------------

## **Hi Therm® 1200mm lengths - FHTMB150**

6 x Pipes or more (price each)	
--------------------------------	--

150mm	87.00
-------	-------

# Starter Ring



**Suggested  
Retail only  
(incl GST)**

## **Starter Ring - SR**

150mm Starter Ring	19.00
--------------------	-------

**To improve the fit of 150mm dia. Flue Pipe into the heater Flue Pipe Spigot**

# Outer Casings Galvanised

Suggested  
Retail only  
(incl GST)



## 1200mm lengths - OC25012

200mm	40.00
225mm	44.00
<b>250mm</b>	<b>45.00</b>
275mm	50.00
300mm	50.00
325mm	56.00
350mm	60.00
375mm	66.00
400mm	71.00
450mm	80.00
500mm	103.00
550mm	124.00
600mm	136.00

## 900mm lengths - OC2509

200mm	35.00
<b>250mm</b>	<b>39.00</b>
300mm	45.00
325mm	48.00
350mm	50.00

## 600mm lengths - OC2506

200mm	26.00
225mm	28.00
<b>250mm (crimped only)</b>	<b>28.00</b>
275mm	35.00
300mm	35.00
325mm	37.00
350mm	38.50
400mm	45.00
450mm	53.00

# Outer / Inner Casing Combinations



**1800 Illustrated**  
Outer / Inner Casing  
Combinations are supplied with  
1200mm of Inner Casing only

Suggested  
Retail only  
(incl GST)

## 1200mm lengths - OIC25012 (No Outer Casing Slip Extension)

<b>250/200mm</b>	<b>93.00</b>
<b>250/200mm (Stainless Steel Outer)</b>	<b>159.00</b>
275/225mm	110.00
300/250mm	115.00
325/275mm	128.00
350/300mm	136.00

## 1800mm lengths - OIC25018 (with 600mm long Outer Slip Extension)

<b>250/200mm</b>	<b>115.00</b>
<b>250/200mm (Stainless Steel Outer)</b>	<b>215.00</b>
275/225mm	140.00
300/250mm	147.00
325/275mm	161.00
350/300mm	170.00

## 2400mm lengths - OIC25024 (with 1200mm long Outer Slip Extension)

<b>250/200mm</b>	<b>131.00</b>
------------------	---------------

# Outer Casing Slip Extensions Galvanised



## 1200mm lengths - OCSE25212

<b>252mm</b>	<b>45.00</b>
277mm	53.00
302mm	53.00
352mm	64.00

## 600mm lengths - OCSE2526

<b>252mm</b>	<b>28.00</b>
277mm	35.00
302mm	35.00
352mm	37.00

# Inner Casings Galvanised

Suggested  
Retail only  
(incl GST)



Plain

## 1200mm Lengths Plain - IC20012

<b>200mm</b>	<b>44.00</b>
225mm	47.00
250mm	49.00
275mm	54.00
300mm	54.00
350mm	63.00

## 600mm Lengths Plain - IC2006

<b>200mm</b>	<b>26.00</b>
225mm	28.00
250mm	28.00
275mm	35.00
300mm	35.00
350mm	38.00



With Upper and Lower Brackets

## 1200mm Lengths Plain with Brackets - ICB20012

<b>200mm</b>	<b>48.00</b>
225mm	59.00
250mm	63.00
275mm	75.00
300mm	75.00
350mm	84.00













# Flue Pipe / Casing Extension Kits

Suggested  
Retail only  
(incl GST)

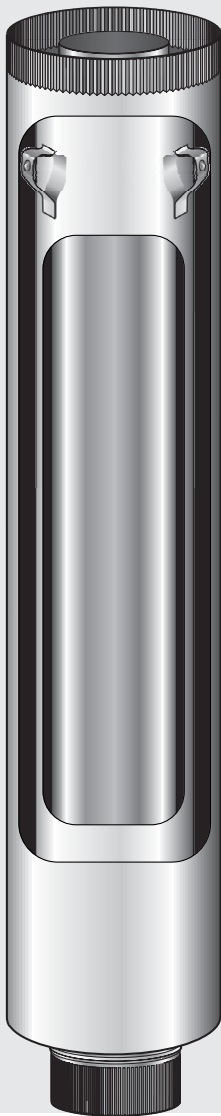

## 1200mm Extension Kit - *FPCEKB25012*

150, 200, 250mm (bracketed inner)	157.00
-----------------------------------	--------

## 1200mm Outer / Inner Extension Kit - *OIEKB25012*

200, 250mm (bracketed inner)	87.00
------------------------------	-------

**NB:** Extension kits have no internal swage ring and are crimped only at the top on the Outer Casing to allow fitting of Outer Casing Slip Extension. Inner Casings have upper locating brackets only

Illustration shows a cross section of the 1200mm Extension kit

Outside In: 250mm Outer Casing  
200mm Inner Casing with Upper  
Brackets Only  
150mm Flue Pipe

Suggested  
Retail only  
(incl GST)

### Anti Down-Draught Cowl - ADD150

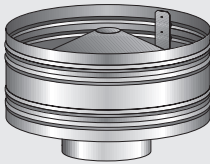

100mm	49.00
108mm	49.00
115mm	49.00
125mm	49.00
<b>150mm</b>	<b>49.00</b>
175mm	59.00
200mm	68.00
225mm	84.00
250mm	101.00
300mm	126.00
325mm	156.00
350mm	156.00
400mm	236.00
450mm	402.00

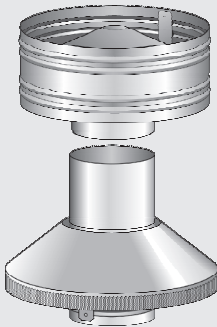

### Anti Down-Draught Combination Cowl - ADDCC150

150mm	115.00
-------	--------

Includes fixed brackets to secure to Outer Casing

**A 150mm ADD Cowl fits over the upstand of Bracketed Casing Cover**

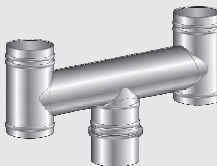

### "H" Tops - HT150

150mm	180.00
-------	--------

# Flue Cows Stainless Steel

Suggested  
Retail only  
(incl GST)

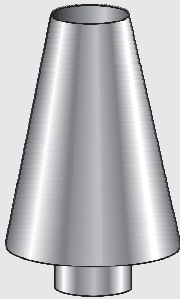

## Rocket Tops - RT150

150mm

126.00

**Under certain conditions these cowls can assist flue draught and vertical smoke discharge**

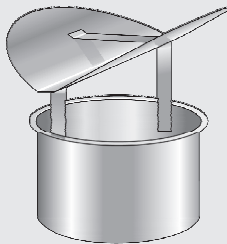

## Butterfly Cowls - BC150

150mm

**66.00**

200mm

79.00

225mm

79.00

250mm

79.00

300mm

94.00

**For use in Terracotta or Copper Chimney Pots**

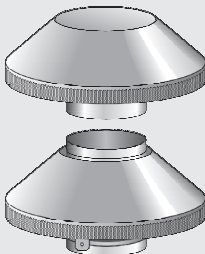

## Low-line Combination Cowls - LLCC150

150mm

107.00

**Replacement for Kent type cowls**

Suggested  
Retail only  
(incl GST)

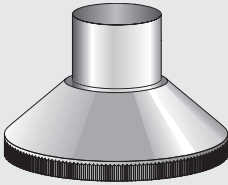

## Stainless Steel - CC150250

100-250mm*	49.00
108-250mm*	49.00
115-250mm*	49.00
125-250mm*	49.00
<b>150-250mm*</b>	<b>49.00</b>
175-275mm*	58.00
200-300mm*	63.00
225-325mm*	75.00
250-350mm*	80.00
275-375mm*	87.00
300-400mm*	87.00
350-450mm*	101.00
400-500mm*	138.00
450-550mm*	178.00

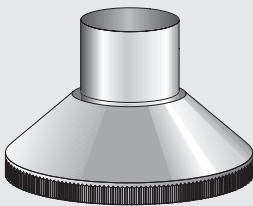

## Oversize Stainless Steel - CC150350

100-300mm*	66.00
<b>150-350mm*</b>	<b>66.00</b>
175-325mm*	75.00
200-350mm*	75.00
225-375mm*	91.00
250-400mm*	87.00
275-425mm*	105.00
300-450mm*	108.00
350-500mm*	128.00
400-550mm*	156.00
450-600mm*	199.00

\*Outer Casing / Chimney Cover Spigot Diameter

# Bird Proofing / Spark Arrestors

Suggested  
Retail only  
(incl GST)



## Stainless Steel Flexible Bird Mesh - BMFG

150mm	120.00
10 or more	120.00

**Mesh extends down, over Outer Casing**

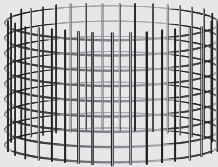

## Stainless Steel Bird Mesh Ring - BPI50SS

150mm	62.00
200mm	65.00
250mm	72.00

**To suit ADD Cowls. Other sizes to order**

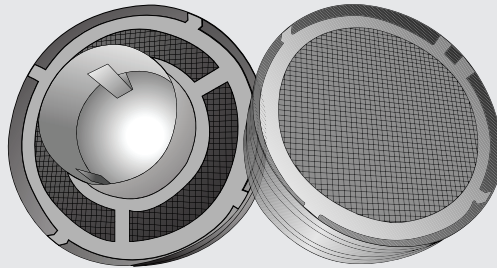

## Spark Arrestors - SASS150

150mm	128.00
200mm	128.00
250mm	128.00
300mm	160.00
350mm	160.00
400mm	160.00

# Flue Pipe Spacer Brackets

Suggested  
Retail only  
(incl GST)

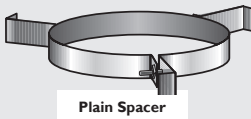
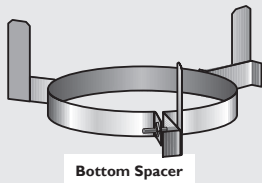
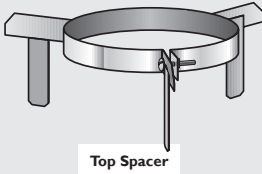

Please specify Top, Bottom, or Plain Spacer when ordering. Unless specified, Top Spacer Brackets will be supplied

## Stainless Steel - FSBT150250

100 to 250mm	19.00
115 to 250mm	19.00
125 to 250mm	19.00
<b>150 to 250mm</b>	<b>19.00</b>
175 to 275mm	24.00
200 to 300mm	24.00
225 to 325mm	30.00
250 to 350mm	31.00
300 to 400mm	31.00
350 to 450mm	37.00
400 to 500mm	45.00
450 to 550mm	54.00

## Oversize Stainless Steel - FSBT150350

150 to 300mm	24.00
<b>150 to 350mm</b>	<b>24.00</b>
175 to 325mm	26.00
200 to 350mm	26.00
225 to 375mm	31.00
250 to 400mm	31.00
300 to 450mm	31.00
350 to 500mm	42.00
400 to 550mm	47.00
450 to 600mm	58.00

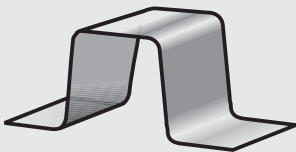

## Spacing Saddles Stainless Steel - FSS

25 x 25 x 25mm	3.00
----------------	------

Minimum Order Quantity of 10



# Ceiling Plates Stainless Steel

Suggested  
Retail only  
(incl GST)

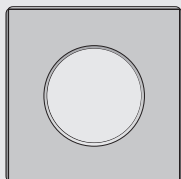

## Flat Ceiling - CPI150

100mm	26.00
108mm	26.00
115mm	26.00
125mm	26.00
<b>150mm</b>	<b>26.00</b>

## Oversize - CPI50460

<b>150mm 460mm square</b>	<b>40.00</b>
150mm 500mm square	49.00

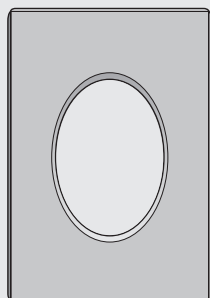

## 30° Ceiling - CPI5030

100mm	47.00
108mm	47.00
115mm	47.00
125mm	47.00
<b>150mm</b>	<b>47.00</b>

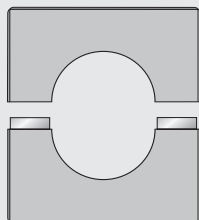

## \*Split Ceiling Plates - CPS150

<b>150mm Flat Ceiling</b>	<b>66.00</b>
150mm 30°	84.00
Other sizes	POA

**\*Made to order**

Please Note: All angle measurements are based off a horizontal 90° take.  
**Please take this into consideration when placing your order**

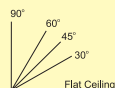

# Trim Plates Stainless Steel

Suggested  
Retail only  
(incl GST)

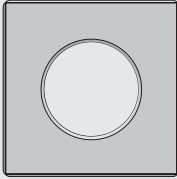

## Flat Ceiling / Floor - CTP255

<b>255mm dia. hole</b>	<b>26.00</b>
280mm dia. hole	30.00
305mm dia. hole	41.00
330mm dia. hole	41.00
355mm dia. hole	49.00
405mm dia. hole	60.00
455mm dia. hole	30.00

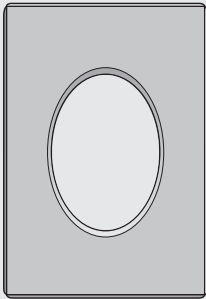

## 30°, 45° Ceiling - CTP25530

<b>255mm dia. hole</b>	<b>47.00</b>
280mm dia. hole	66.00
330mm dia. hole	82.00

# Ceiling Plates Black

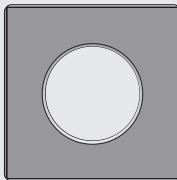

## Ceiling Plates Black - CPB150

150mm Flat ceiling	33.00
--------------------	-------

Please Note: All angle measurements are based off a horizontal 90° take.  
**Please take this into consideration when placing your order**

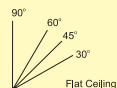

# Floor Penetration Kit E Kit

For use in two storied installations

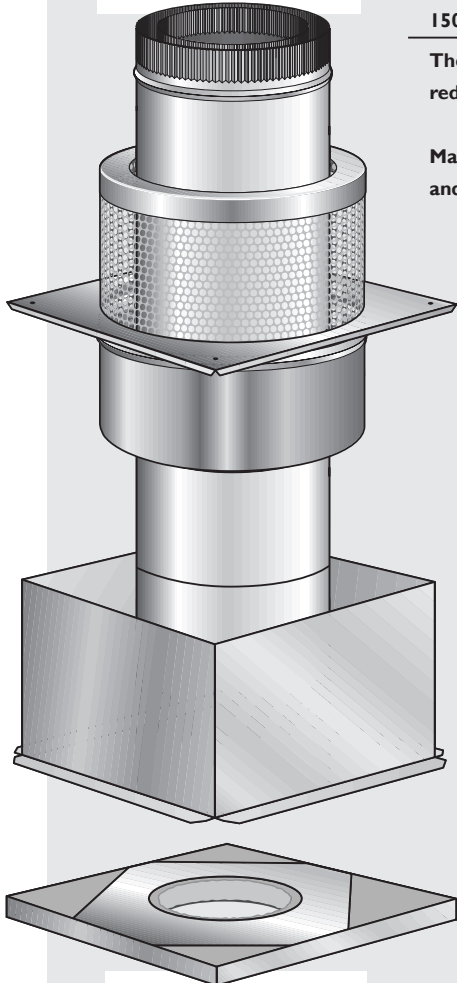

Diagram illustrates 150mm Floor Penetration E Kit with Outer / Inner Casing in position

## Floor Penetration E Kit - EKFP150

150mm unpainted

The easy fitting Floor Penetration E Kit can help reduce noise transfer between upper and lower rooms.

Manufactured in accordance with AS/NZS 2918:2001 and tested to appendix F.

## 150mm Floor Penetration E Kit Option

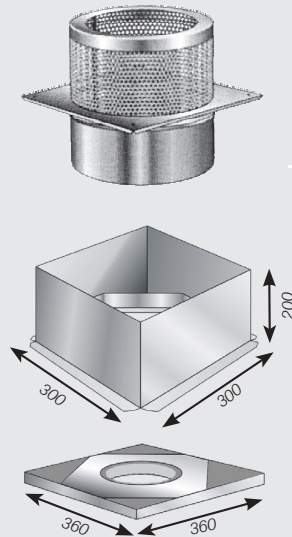

This Kit is designed to be used where the 250/200 Combination Liners extend from the E Kit unit to outside the roof  
**DO NOT USE WITH 250DIA. MESH SCREEN**

# Floor Penetration Units

Suggested  
Retail only  
(incl GST)

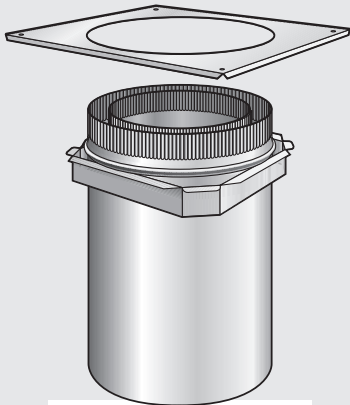

For use in two storied  
installations

## Floor Penetration Unit - FPU250200

250/200mm

84.00

Floor Penetration Extensions must be used when fitting mesh screens. (AS/NZS 2918:2001 4.6.30)

Supplied complete with Trim Plate.  
For use on tested and untested installations  
As per AS/NZS 2918:2001

# Floor Penetration Extensions



## Painted Black 300mm Long - FPE250

250mm

49.00

Extensions are designed to be used when installing 250mm dia. Mesh Screens on Floor Penetrations Units

# Flue Pipe Shields Stainless Steel

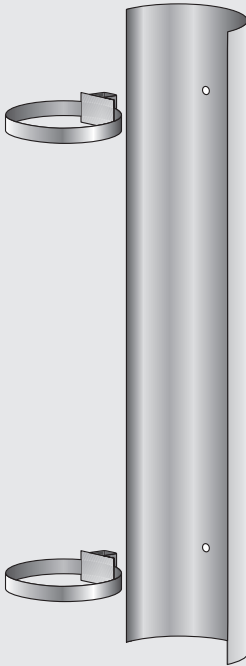

**Suggested  
Retail only  
(incl GST)**

## **1200mm Shields - Complete - FSC150**

100mm	73.00
115mm	73.00
125mm	73.00
<b>*150mm</b>	<b>73.00</b>

**Supplied complete with brackets and bands for mounting to Flue Pipe**

**\*If a Deflector Plate is required please order separately**

## **1200mm Shields with Brackets Only - FSB150**

To fit sizes up to 150mm dia.	65.00
-------------------------------	-------

**Supplied with brackets only for mounting to Flue Pipe.**

**\*If a Deflector Plate is required please order separately**

# Flue Pipe Shield Components

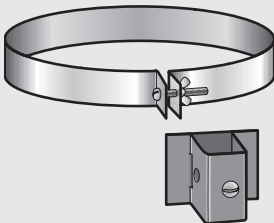

## **Flue Pipe Shield Components - FSBKT**

* Brackets only (pair)	16.00
* Brackets and bands only (pair)	23.00

**\*These components are common to all our Flue Pipe Shields. Upon securing the Brackets to the Flue Pipe with rivets or screws the Flue Pipe Shield Bands may be removed**

**Please ensure Wood Burner manufacturer's Flue Pipe Shield specifications and AS/NZS 2918:2001 are strictly adhered to**

# Flue Pipe Shields Double

**Suggested  
Retail only  
(incl GST)**



## **Universal Double Shield - FSUDB**

Black

128.00

As specified for Pioneer range of Wood Burners  
Complete with Brackets for mounting to Flue Pipe / Wood Burner

**Please ensure Wood Burner manufacturer's Flue Pipe Shield specifications and AS/NZS 2918:2001 are strictly adhered to.**

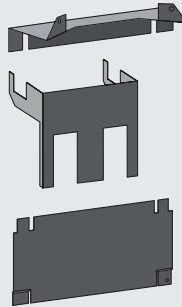

# Loose Fill Insulation Boundary

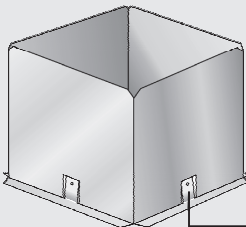

## **Galvanised - LFIB250**

250mm square

38.00

For use in ceiling space where insulation material needs to be retained

**Outer Casing Location Tabs**

# Flue Pipe Screens



**Suggested  
Retail only  
(incl GST)**

## **½ & ½ Mesh Front / Reflector Backed - MSRB250**

<b>250mm</b>	<b>122.00</b>
300mm	154.00



## **Full Mesh - MS250**

<b>250mm</b>	<b>115.00</b>
300mm	154.00



## **Painted Black - MSRBB250**

<b>250mm ½ &amp; ½</b>	<b>156.00</b>
------------------------	---------------

If Plain Spacer Brackets are required please order separately  
Flue Pipe Screens are 1200mm long  
For use in two storied installations

# Flue Pipe Screens



**Suggested  
Retail only  
(incl GST)**

## **1/2 & 1/2 Mesh Front / Reflector Backed - MSRB250**

<b>250mm</b>	<b>122.00</b>
300mm	154.00



## **Full Mesh - MS250**

<b>250mm</b>	<b>115.00</b>
300mm	154.00



## **Painted Black - MSRBB250**

<b>250mm 1/2 &amp; 1/2</b>	<b>156.00</b>
----------------------------	---------------

If Plain Spacer Brackets are required please order separately  
Flue Pipe Screens are 1200mm long  
For use in two storied installations



# Combination Tee-Pieces

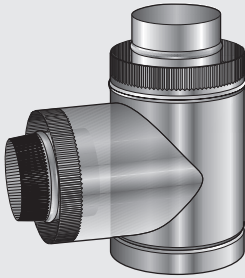

Suggested  
Retail only  
(incl GST)

**90° - TPC150250**

150/250mm

235.00

**\*Suitable for use with SFP Wall Penetration Units.  
Stainless Steel Flue Pipe, Galvanised Outer Casing**

## 150mm Wall Penetration Units

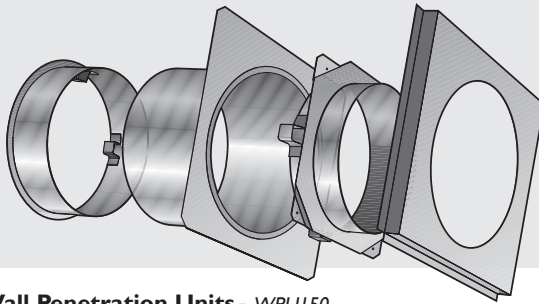

**150mm Wall Penetration Units - WPU150**

250/200mm

196.00

**To suit installations using 250mm Outer Casing with Flue Pipe diameters up to 150mm**

**Trim Plate / Wall Plate not supplied with Wall Penetration Unit  
Please order separately**

**For use on tested and untested installations as per AS/NZS 2918:2001**

**It is the responsibility of the installer to ensure that the requirements of the New Zealand Building Code's Clause E2 (External Moisture) are complied with**

# Chimney Flashing Plates

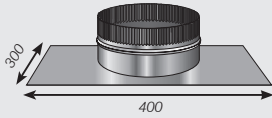

**Suggested  
Retail only  
(incl GST)**

## Galvanised - CFPG250

250mm	37.00
-------	-------

## Stainless Steel - CFPSS250

250mm	45.00
-------	-------

# Support Angles

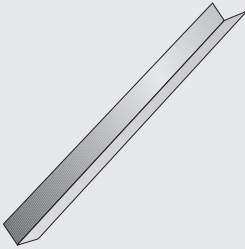

## Galvanised - SA2512

600mm	25x25mm	8.00
-------	---------	------

<b>1200mm</b>	<b>25x25mm</b>	<b>12.00</b>
---------------	----------------	--------------

2400mm	25x25mm	14.00
--------	---------	-------

600mm	50x50mm	10.00
-------	---------	-------

1200mm	50x50mm	14.00
--------	---------	-------

2400mm	50x50mm	18.00
--------	---------	-------

600mm	75x75mm	12.00
-------	---------	-------

1200mm	75x75mm	16.00
--------	---------	-------

2400mm	75x75mm	23.00
--------	---------	-------

# Reducers / Adaptors

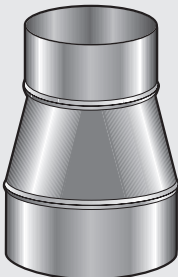

## Stainless Steel - R /

Between any two of these sizes

<b>100 to 150mm</b>	<b>63.00</b>
---------------------	--------------

150 to 200mm	68.00
--------------	-------

200 to 300mm	91.00
--------------	-------

**If specified length required add**

**PLEASE NOTE:** These items require a detailed description as inside / outside diameters & crimping options are critical

## Outer Casing Trim Caps

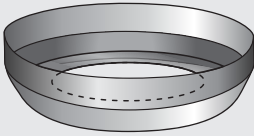

**Suggested  
Retail only  
(incl GST)**

### **Galvanised - OCTC250**

<b>250/180mm</b>	<b>33.00</b>
300/155mm	45.00
Other hole sizes to order	

## Outer Casing Converters

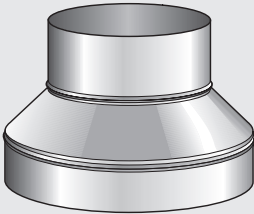

### **Galvanised - OCC300250**

<b>300mm to 250mm</b>	<b>73.00</b>
350mm to 250mm	73.00
355mm to 250mm (Visor)	73.00
Specials sizes to order	

**For conversion of larger size Outer Casings to 250mm diameter**

## Outer Casing Blanking Caps

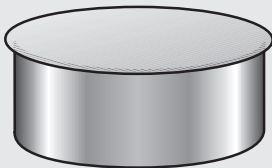

### **Galvanised - OCBC250**

<b>250mm</b>	<b>30.00</b>
300mm	33.00
350mm	37.00

## Two Piece Brackets

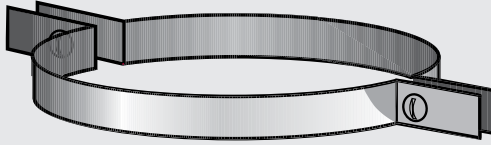

**Suggested  
Retail only  
(incl GST)**

**Galvanised - WBSBS250**

**250mm**

**51.00**

## Wall Standoff Brackets

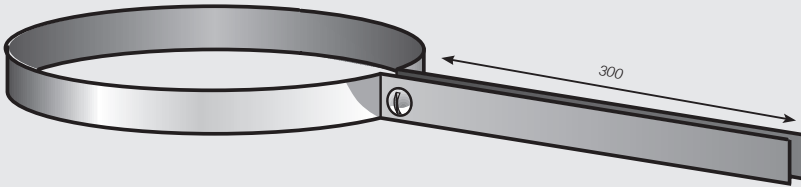

**Galvanised - WSB250**

**250mm**

**44.00**

300mm

49.00

350mm

54.00

400mm

58.00

**Stainless Steel - WSBSS250**

**250mm**

**75.00**

300mm

84.00

350mm

93.00

400mm

101.00

# Flexi-Flue Pipe



For use in masonry chimneys only  
Type 316L Stainless Steel

**Suggested  
Retail only  
(incl GST)**

## **Stainless Steel - FFSS100I** (1.0 metre length)

75mm	84.00
<b>100mm</b>	<b>98.00</b>

## **Stainless Steel - FFSS150** (1.5 metre length)

125mm	201.00
<b>150mm</b>	<b>210.00</b>
200mm	259.00

Extreme care is required when handling, installing and maintaining Flexi-Flue Pipe. Flexi-Flue Pipe supplied to SFP is manufactured with 316L Stainless Steel .13mm to comply with AS/NZS2918.2001 2.3(a)

# Flexi-Flue Reducers / Adapters

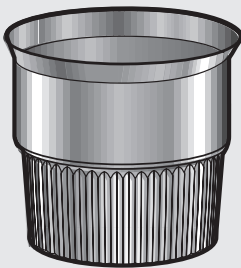

**Suggested  
Retail only  
(incl GST)**

## **Stainless Steel - FFASS150**

<b>From 150mm Flue Pipe / Wood burner Flue Spigot to 150mm Stainless Steel Flexi-Flue</b>	<b>31.00</b>
---	--------------

<b>From 125mm Flue Pipe / Wood burner Flue Spigot to 125mm Stainless Steel Flexi-Flue</b>	<b>31.00</b>
---	--------------

<b>From 150mm Flue Pipe / Wood burner Flue Spigot to 125mm Stainless Steel Flexi-Flue</b>	<b>60.00</b>
---	--------------















# OFFSET & BENDS



# Combination Offsets 45°

Suggested  
Retail only  
(incl GST)

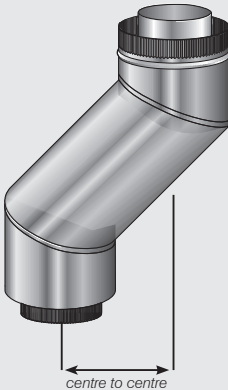

## Single Casing - COSC45/50250 Priced Up to 500mm c to c

150/250mm	172.00
200/300mm	215.00
225/325mm	234.00
250/350mm	258.00
275/375mm	313.00
300/400mm	356.00
350/450mm	482.00
400/500mm	533.00

**Single Casing Offsets are not supplied with internal spacers**

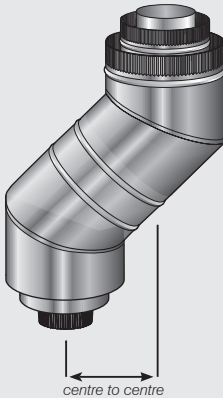

## Double Casing - CODC45/150 Priced Up to 500mm c to c

150/200/250mm	390.00
175/225/275mm	475.00
200/250/300mm	510.00
250/300/350mm	560.00
300/350/400mm	POA

**Minimum Offset 220mm centre to centre at 45°  
Offsets less than 220mm centre to centre at POA**

## Double Casing

Above 500mm c to c POA

**Please state offset (centre to centre) when ordering**

Please Note: All angle measurements are based off a vertical 90° take.  
**Please take this into consideration when placing your order**



# Telescopic Offsets 45°

These allow for a range of offsets, with the angle fixed at 45°

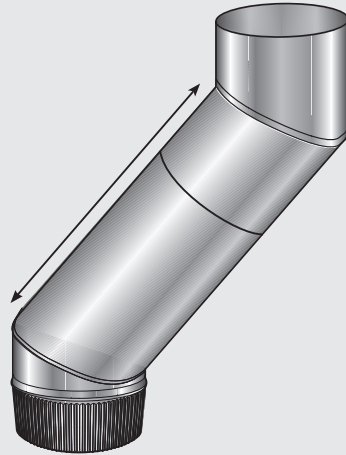
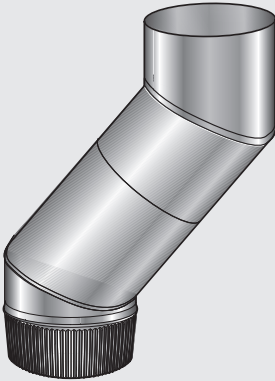

**Suggested  
Retail only  
(incl GST)**

## **Stainless Steel - TOSS45150**

100mm	72.00
115mm	72.00
125mm	72.00
<b>150mm</b>	<b>72.00</b>
175mm	108.00
200mm	108.00
225mm	128.00
250mm	128.00
300mm	164.00
350mm	189.00

## **Galvanised - TOG45250**

200mm	75.00
<b>250mm</b>	<b>86.00</b>
300mm	91.00
325mm	103.00
350mm	103.00
400mm	122.00
450mm	157.00

# Combination Fixed Bends 45°

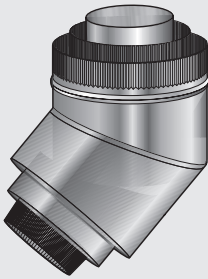

**Suggested  
Retail only  
(incl GST)**

## Double Casing - CFB45150

<b>150/200/250mm</b>	<b>143.00</b>
175/225/275mm	156.00
200/250/300mm	156.00
225/275/325mm	210.00
250/300/350mm	210.00
300/350/400mm	280.00

All other sizes & 30° angles to order

# Fixed Offsets 45°

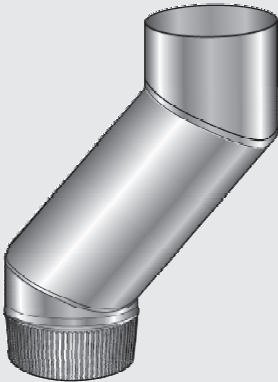

## Stainless Steel - FOSS45150 up to 500mm $\phi$ to $\phi$

100mm	87.50
115mm	87.50
125mm	87.50
<b>150mm</b>	<b>87.50</b>
175mm	128.00
200mm	128.00
225mm	136.00
250mm	136.00
300mm	178.00
350mm	201.00
More than 500mm $\phi$ to $\phi$	POA

**NOTE:** These offsets are only made to order using 30° or 45° angles. Please specify angle and offset (centre to centre) when ordering

Please Note: All angle measurements are based off a vertical 90° take.  
**Please take this into consideration when placing your order**



## Fixed Bends 45°

Suggested  
Retail only  
(incl GST)

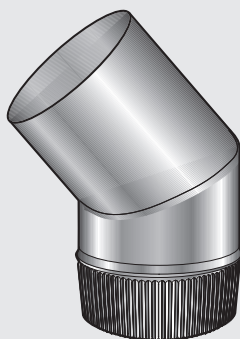

### Stainless Steel - FBSS45150

100mm	37.00
108mm	37.00
115mm	37.00
125mm	37.00
<b>150mm</b>	<b>37.00</b>
175mm	49.00
200mm	49.00
225mm	61.00
250mm	61.00
275mm	73.00
300mm	73.00
325mm	89.00
350mm	89.00
400mm	100.00
450mm	128.00

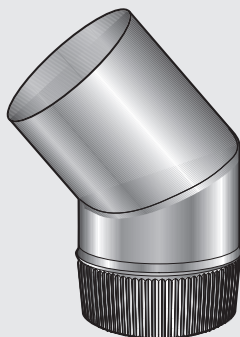

### Galvanised - FBG45250

200mm	37.00
<b>250mm</b>	<b>42.00</b>
300mm	52.00
325mm	58.00
350mm	58.00
400mm	66.00
450mm	82.00
500mm	120.00
550mm	138.00

All other sizes and angles to order

## Fixed Bends 90°

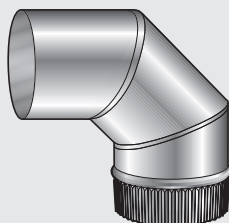

### Stainless Steel - FBSS90150

100mm	56.00
125mm	56.00
<b>150mm</b>	<b>56.00</b>



# Adjustable Bends



Bends adjustable from 0° to 90°

**Suggested  
Retail only  
(incl GST)**

## **Stainless Steel - ABSS/50**

100mm	59.00
125mm	59.00
<b>150mm</b>	<b>59.00</b>
175mm	75.00
200mm	91.00
225mm	103.00
250mm	103.00
300mm	124.00
350mm	150.00
375mm	185.00
400mm	202.00
450mm	239.00

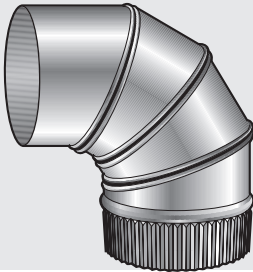

Bends adjustable from 0° to 90°

## **Galvanised - ABG/50**

100mm	30.00
125mm	30.00
<b>150mm</b>	<b>30.00</b>
175mm	42.00
200mm	47.00
225mm	56.00
250mm	56.00
275mm	80.00
300mm	80.00
350mm	107.00
375mm	114.00
400mm	136.00
450mm	163.00
500mm	173.00
550mm	208.00
600mm	252.00









**FIREPLACE &  
INSTALLATION  
ACCESSORIES**



**Suggested  
Retail only  
(incl GST)**

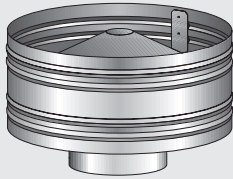

## Copper Anti Down-Draught Cows

Stainless Steel sheathed in copper

150mm	114.00
200mm	166.00
225mm	210.00
250mm	210.00
275mm	POA
300mm	POA
350mm	POA

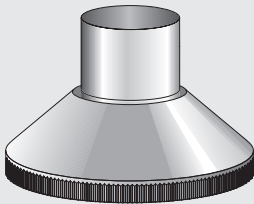

## Copper Casing Covers

Stainless Steel sheathed in copper

150mm - 250mm*	201.00
200mm - 300mm*	223.00
225mm - 325mm*	271.00
250mm - 350mm*	271.00
275mm - 375mm*	POA
300mm - 400mm*	POA
350mm - 450mm*	POA

**\*Outer Casing / Chimney Cover Spigot Diameter**

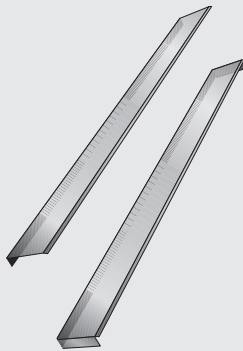

## Copper Trim for Chimney Covers

Per Each	POA
Up to 1000mm long	POA
1000 - 1500mm long	POA
1500 - 2400mm long	POA

**Please specify required lengths when ordering**

**NB: Do not use copper trims on galvanised Chimney Covers**

**SFP will not be responsible for any damage caused by run-off onto the other metal surfaces**

**\*Prices are subject to change, please check validity at time of order**

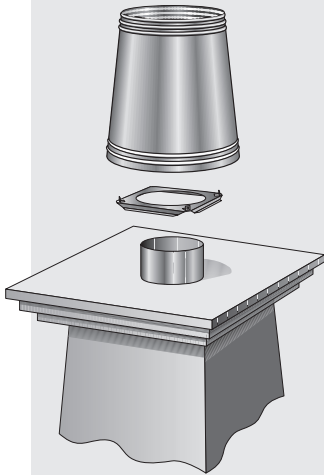

**Suggested  
Retail only  
(incl GST)**

## Copper Chimney Pots

Small	516.00
-------	--------

To suit 150, 200, 225 Cowl Assemblies

Large	612.00
-------	--------

To suit 150 through to 300 Cowl Assemblies

**Please specify spigot size of Chimney Cover to be used with Base Plate and Chimney Pot**

**Price includes Base Plate. Can help reduce wind noise**

**If cowl assembly is required please state when ordering**



## Copper Outer Casings

1200mm lengths

250mm	POA
-------	-----

300mm	POA
-------	-----

325mm	POA
-------	-----

350mm	POA
-------	-----

375mm	POA
-------	-----

**NB. Do not use Copper Outer Casings with Galvanised Outer Casings**

**SFP will not be responsible for any damage caused by run-off onto other metal surfaces**

**\*Prices are subject to change, please check validity at time of order**



# Chimney Covers

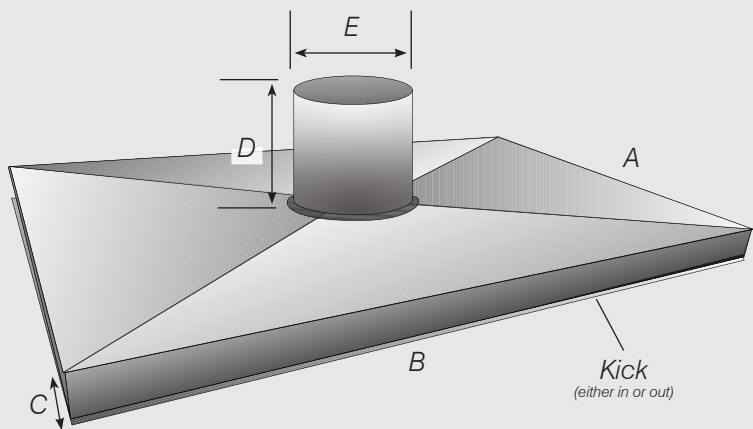

## Stainless Steel - CHCO1199

A+B Internal dimensions

Up to 799mm

800 - 1199mm

1200 - 1599mm

1600 - 1999mm

2000-2390mm

Large Sizes

*\*Out of square options available*

**Excludes freighting costs.**

**\*When measuring chimney check the diagonal measurements to ensure the chimney is square. If measurements vary then the chimney is out of square and template must be supplied. Template must be plywood, MDF or similar rigid material**

**N.B. Refer to heater manufacturers recommendations to ensure adequate ventilation of chimney**

SFP manufacture Chimney Covers to dimensions or templates supplied. It is the responsibility of the installer to ensure that the requirements of the **New Zealand Building Code Clause E2 (External Moisture)** are complied with

### Measurements

A  D   
B  E   
C

### Kick

In   
Out

### Other Instructions

\_\_\_\_\_  
\_\_\_\_\_  
\_\_\_\_\_

# Coal Range Flue Components

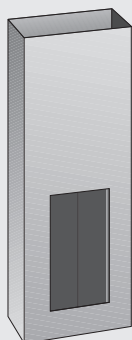

**Suggested  
Retail only  
(incl GST)**

## Coal Range Base Flues - CRBF

Shacklock 501 245 x 90mm	154.00
Shacklock No.1 245 x 90mm	154.00
Other sizes	

## Square to Round Transitions - SR501

<b>Shacklock 501 to 150mm</b>	<b>154.00</b>
Shacklock No.1 to 175mm	154.00
Flat-backed, to 150 or 175mm	190.00

# Galvanised Ashpans

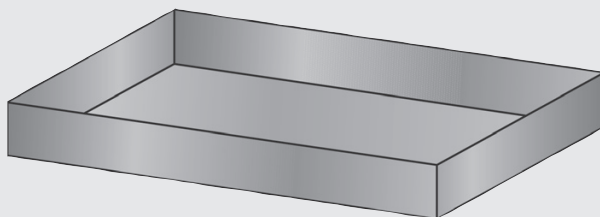

## Small Rectangular - ASH1

Up to 250 x 500mm	66.00
-------------------	-------

## Large Rectangular - ASH2

Larger than 250 x 500mm	POA
<i>If handle is required: add</i>	<i>+21.00</i>

# Fireplace Accessories

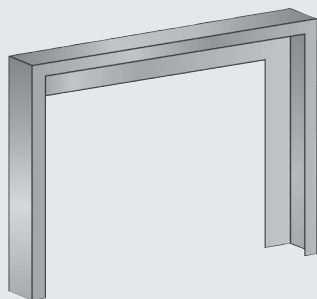

**Suggested  
Retail only  
(incl GST)**

## Insert Spacers - FAIS

Unpainted	104.00
-----------	--------

**One piece. Specify width, height and depth when ordering**

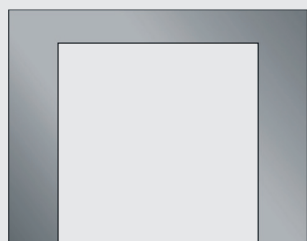

## Oversize Surround / Fascias - FAOS

Unpainted up to 1200mm wide	130.00
-----------------------------	--------

Unpainted over 1200mm wide	
----------------------------	--

**One piece. Specify width and height when ordering**



## Mantel Shelf Heat Shields - MSHSB

<b>Black</b>	<b>52.00</b>
--------------	--------------

*Unpainted	30.00
------------	-------

**\*Differing heights, depths and widths can be manufactured. Specify dimensions when ordering**

# Fibreglass Door Rope

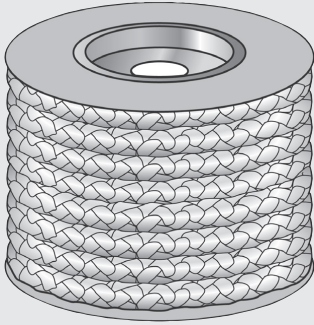

**Suggested  
Retail only  
(incl GST)**

## 50 metre rolls - FDR1350

6mm	116.00
10mm	181.00
<b>13/14mm</b>	<b>239.00</b>
15/16mm	309.00

## 10 metre rolls - FDR1310

6mm	49.00
10mm	53.00
<b>13/14mm</b>	<b>68.00</b>
15/16mm	80.00

# Fibreglass Ladderback Tape

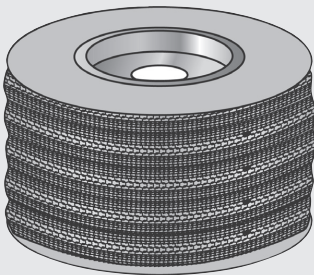

## 50 metre rolls - FDRLB2550

25mm	224.00
------	--------

## 10 metre rolls - FDRLB2510

25mm	72.00
------	-------

# Fire Cement

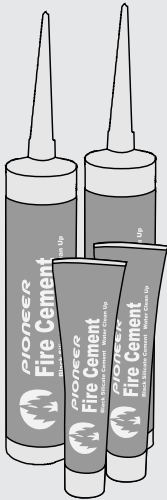

**Suggested  
Retail only  
(incl GST)**

## **Pioneer Cartridges - FCPC**

300ml	21.00
-------	-------

## **Pioneer Tube - FCPT**

70ml tubes	10.00
------------	-------

**Comes in a carton of 12**

**Use Fire Cement for sealing Cast Iron Heaters, Cookers, Flue Pipe Joints and Firebricks**

# Touch-Up Paint



## **Aerosol Stovebright® - SBAMB**

Can	31.00
Carton of 6 (price per each)	29.00
Carton of 12 (price per each)	28.00

**COLOURS: Metallic Black, Satin Black**

**Dangerous Goods charges and packing applies to orders less than six cans**

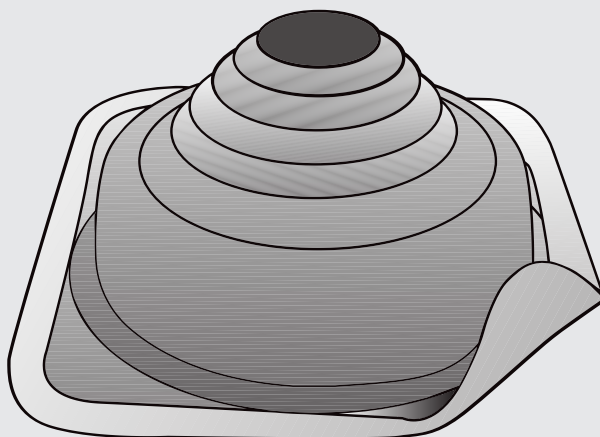

**Suggested  
Retail only  
(incl GST)**

#### **Dektite Flexible Flashings - DFE107B**

NO.3 5-127	41.00
NO.4 75-175	44.00
<b>NO.7 150-300</b>	<b>103.00</b>
NO.8 170-355	129.00
NO.9 230-508	168.00

#### **10 Packs Dektite Flexible Flashings**

NO.4 75-175 (Price per each)	41.00
NO.7 150-300 (Price per each)	103.00

#### **5 Packs Dektite Flexible Flashings**

NO. 9 230-508 (Price per each)	158.00
--------------------------------	--------

**Suggested  
Retail only  
(incl GST)**

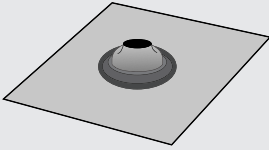

## Lead Tile Flash - TFL150300

TFL 75-175	158.00
<b>TFL 150-300</b>	<b>316.00</b>

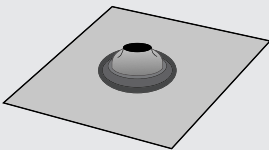

## Aluminium Tile Flash - TFA160300

<b>TFA 160-300</b>	<b>230.00</b>
TFA 300-450	356.00

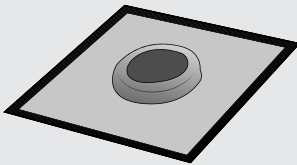

## Dektite Soaker Flashings - DF605

**For low, medium or high pitched roofs where damming is a risk**

DF 603 114-254mm	136.00
<b>DF 605 255-410mm</b>	<b>221.00</b>
DF 606 410-610mm	522.00

The Dektite® Soaker™ has a large base to reduce and divert rainwater back up that can occur on very low or high pitched roofs and deep ribbed roofing profiles

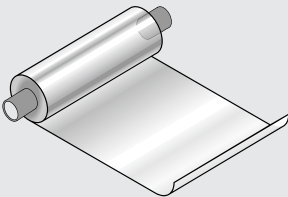

## Lead Sheet - LEADA3

**17kgm<sup>2</sup> 600mm Wide x 3 Metre Rolls**

<b>Acrylead</b>	<b>520.00</b>
Plain Lead	496.00

# Installation Accessories

**Suggested  
Retail only  
(incl GST)**

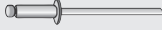

## **Stainless Steel Pop-Rivets - PRSS44**

Per 500 SS 4.4	64.00
----------------	-------

**Packed in convenient screw top containers**

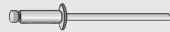

## **Monel Steel Pop-Rivets - PRMS44**

Per 500 Monel 4.4	111.00
-------------------	--------

**Packed in convenient screw top containers**



## **1/8" Double Ended Drills - DED**

Packet of 10	40.00
--------------	-------



## **All purpose Silicone Sealant - SSC**

300gm Cartridges	13.00
------------------	-------

Carton of 20 (price per each)	10.00
-------------------------------	-------



## **Tek Screws - TS10-16**

10-16 x 16 CL4	
----------------	--

Per Packet of 100	24.00
-------------------	-------

**Includes free 5/16 socket bit**



## **Ceramic Screws - CSS**

Packets of 4x spacers and screws	7.00
----------------------------------	------

**Minimum Order Quantity 10**









